

linear units

"Control in motion"

LT55 SERIES

Compact linear units
with internal rail guide



LINEAIRTECHNIEK®

by

ALMOTION®

LT55 SERIES

Compact linear units
with internal rail guide



- Compact design, the width of the profile 55 mm
- Internal recirculating ball rail guide size -15 -
- Double carriage design for heavier loads
- Magnetic switches in T-slot for position detection
- Toothed belt type 25 AT5

TECHNICAL DATA

LT55-TR-S15D

| | | |
|-------------------------|------------------|-------|
| Maximum stroke length | mm | 5.750 |
| Maximum speed | mm/s | 3.000 |
| Maximum acceleration | m/s ² | 30 |
| No load torque | Nm | 0,9 |
| Repeatability | mm | ± 0,1 |
| Movement per revolution | mm | 150 |

LT55 SERIES

TECHNICAL DATA

LOAD CAPACITY LT55-TR-S15D

| | | |
|----|----|-------|
| Mx | Nm | 106 |
| My | Nm | 106 |
| Mz | Nm | 40 |
| Fx | N | 1.200 |
| Fy | N | 3.400 |
| Fz | N | 3.600 |

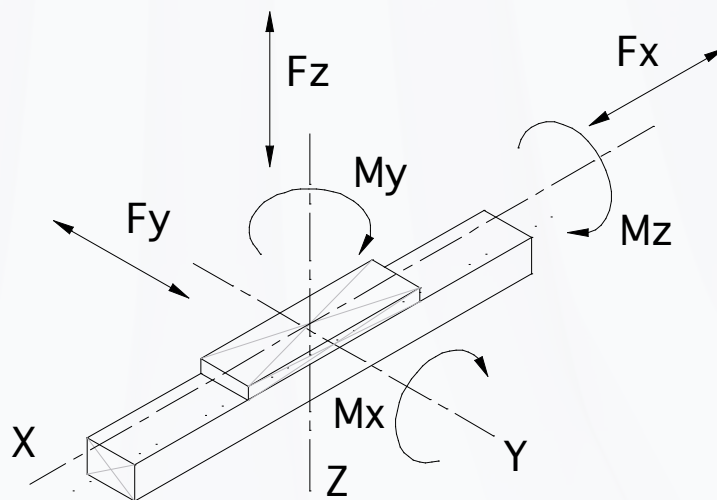

WEIGHTS (KG)

LT55-TR-S15D

| | |
|--------------------------|------|
| Unit weight 0 mm stroke | 3,69 |
| Weight per 100 mm stroke | 0,40 |
| Mass of carriage | 0,97 |

LT55 SERIES

DIMENSIONS

DIMENSIONS LT55-TR-S15D

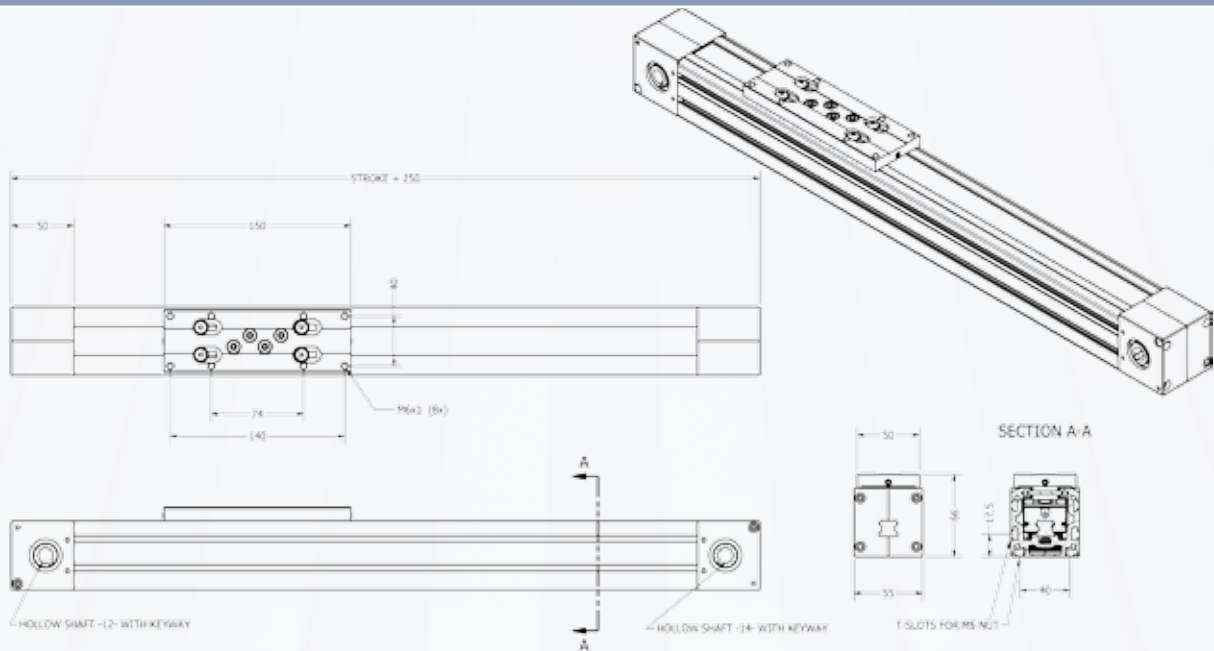

CLAMPING DIMENSIONS

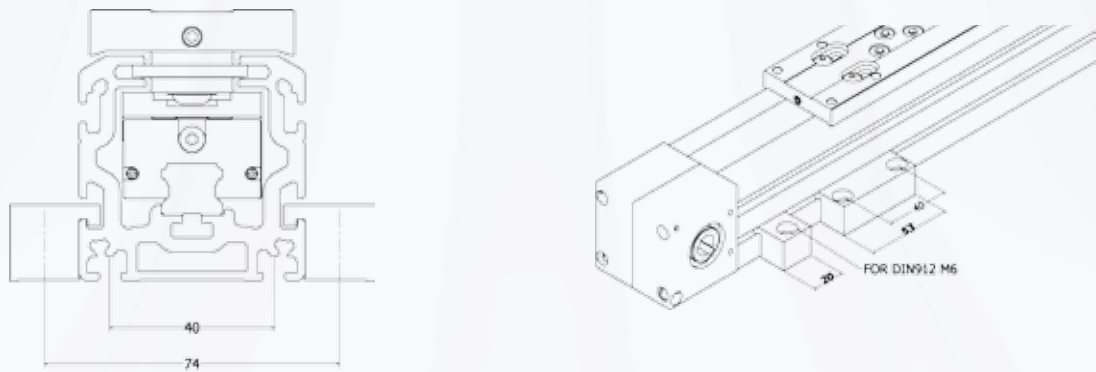

DIMENSIONS FOR MOUNTING

DIMENSIONS FOR MOTOR ATTACHEMENT

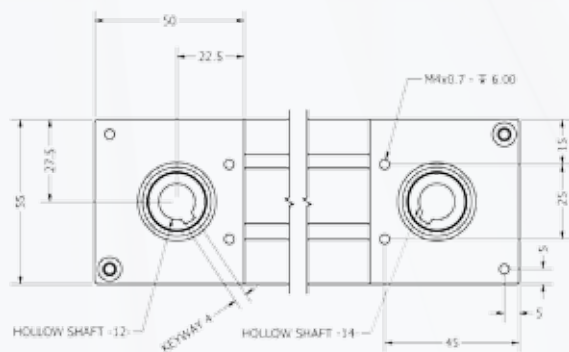
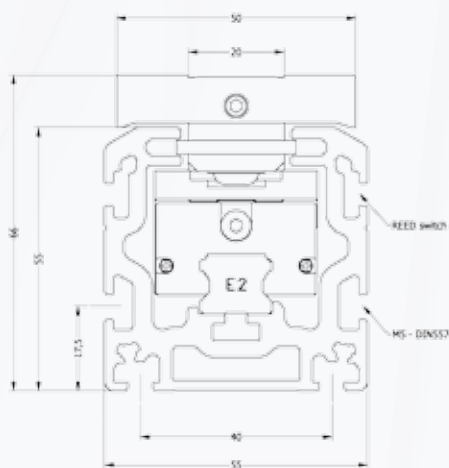

LT55

MOTOR ACCESSORIES

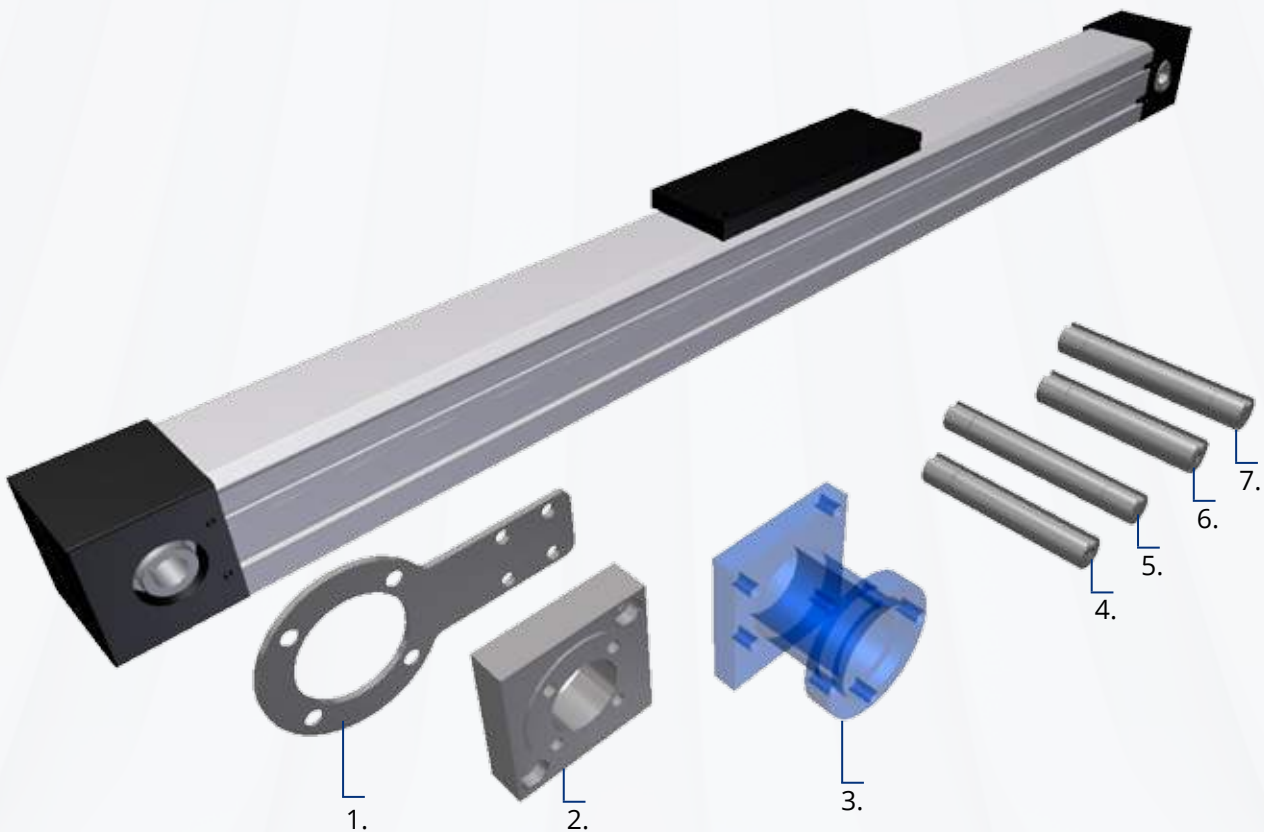

| | | |
|---|-----------------|-----------------------|
| 1 | 5570-RA-M-XXX | Motor adaptor armtype |
| 2 | 5570-F-XXX | Motor Flange |
| 3 | 5570-FL-XXX | Motor adaptor |
| 4 | 5070-SS-12-GS14 | Single shaft ø12 |
| 5 | 5070-DS-12-GS14 | Double shaft ø12 |
| 6 | 5070-SS-14-GS14 | Single shaft ø14 |
| 7 | 5070-DS-14-GS14 | Double shaft ø14 |

LT55-TR-S15D

ACCESSORIES

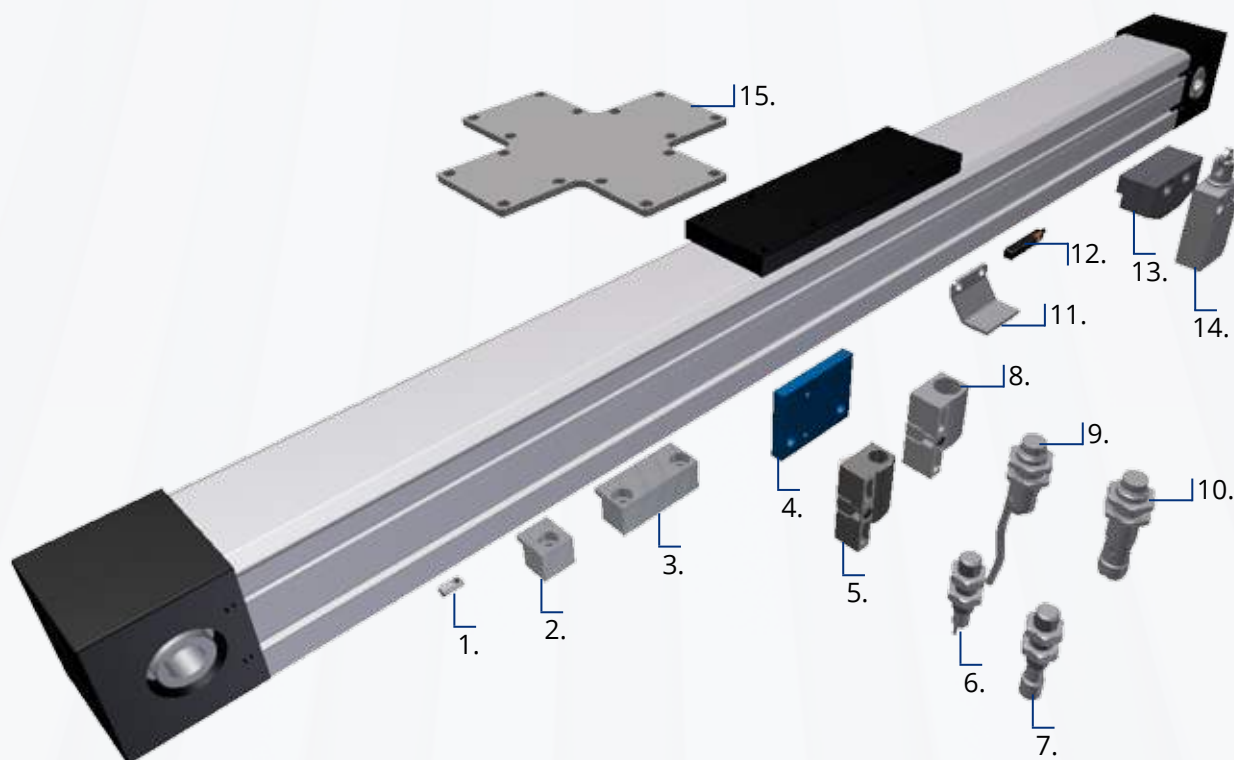

| | | |
|----|--------------|----------------------------|
| 1 | 111-012 | Nut M5 |
| 2 | 55121 | Clamping plate single |
| 3 | 55122 | Clamping plate double |
| 4 | 5570-SH-XS | Bracket for Telem. bracket |
| 5 | XSZB108 | Bracket for M8 sensor |
| 6 | XS4p08pa340 | M8 inductive sensor-cable |
| 7 | XS4p08pa340s | M8 inductive sensor-M8 |
| 8 | XSZB112 | Bracket for M12 sensor |
| 9 | XS212b4pal | M12 inductive sensor-cable |
| 10 | XS212b4pbm | M12 inductive sensor-M8 |
| 11 | 5570-DB4-IN | Sensor Bracket |
| 12 | ASV1-C525 | Reed switch |
| 13 | 5570-SD-ME | Switch bracket |
| 14 | XCMD2102L | Switch with roll |
| 15 | 5570-XP-D | X-Cross-bracket |

Worldwide support for linear units.
Please contact us for your local
technical assistant.



LINEAIRTECHNIEK® by **ALMOTION**®

ISO 16016:2000

Technical product documentation - Protection notices for restricting the use of documents and products.

Almotion bv

Nijverheidsweg 14
6662 NG ELST (Gld.)
The Netherlands

T: 0031 488 480 858

F: 0031 488 481 165

E: info@almotion.nl

I : www.almotion.nl

I : www.lineair.nl

I : www.lineairegeleiding.nl